



Attachment

Hammer on Beam Clamp for Side Mount



Provides a mounting base for securely and easily fastening hardware to a steel beam

Features:

- Manufactured from spring steel with black epoxy coating
- Designed to fit flanges 1/8" to 1/2" thick
- 1/4" side mounting hole
- Use with a multitude of cable management hardware
- UL & CUL listed

Application:

- Provides base support to attach j hooks, s hooks, chain, 1/4" bolt or other apparatus from beam flanges
- Used to suspend building services installations including cable tray, conduit, pipework, etc

Installation:

- Attaches to beam flange 1/8" to 1/2" thick
- Secure to beam flange using hammer



WHOK-24
For 1/8" to 1/4" flange



WHOK-58
For 5/16" to 1/2" flange

Part Numbers

Part #	Description	Box Qty	12-digit UPC
WHOK-24	Hammer on Beam Clamp for 1/8"-1/4" Flange, Side Mount	100	811443030536
WHOK-58	Hammer on Clamp for 5/16"-1/2" Flange, Side Mount	100	811443030543

Specify Winnie...

- ✓ Since 2015
- ✓ Family-Owned & Operated
- ✓ Personal & Friendly Customer Service

Consult & follow local codes and practices

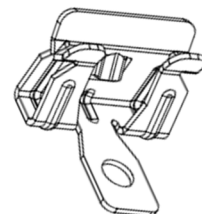
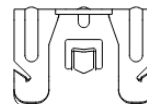
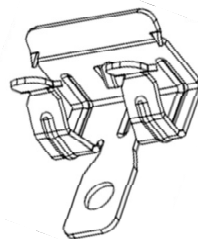

© Winnie Industries, LLC. All Rights Reserved. Drawings are proprietary and may not be copied or used without express written permission.

Rev 202405

engineered and manufactured to make installs easier

winnieindustries.com



5420 Newport Dr. Unit 62
Rolling Meadows, IL 60008

224-993-0011
sales@winnieindustries.com