

Structural Attachment Instruction Sheet

Mounting to a threaded rod, ceiling or other horizontal surface using an angle clip

WAC, WACSS, WAC12-300, WAC38, WAC4T-300, WANGLE4T, WANGLE4TSS

Placing at desired height, mount the angle clip to threaded rod with (2) 1/4x20 nuts; the angle clip may be mounted directly to the ceiling or other horizontal surface using an appropriate fastener



Mounting to a beam with a screw-on spring steel beam clamp

WSSBC

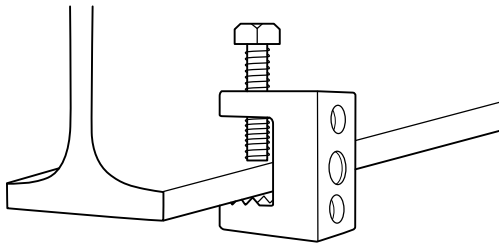

Secure the spring steel beam clamp to a flange using a socket driver or Philips head screwdriver

Note: The SSBC is designed for flanges up to 1/2" thick

Mounting to a beam with a screw-on pressed steel beam clamp

WPBC

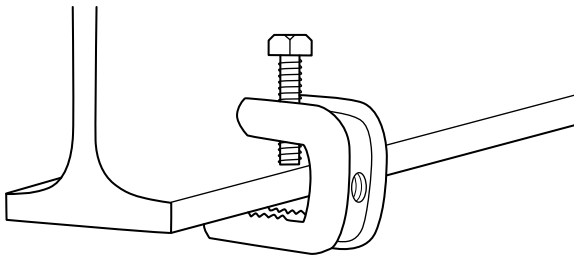

Secure the pressed beam clamp to a flange using a socket driver or Philips head screwdriver

Note: The WPBC is designed for flanges up to 1/2" thick

Mounting to threaded rod or ceiling wire with a batwing (multi-function) clip

WBW34, W6Z34, W8Z34

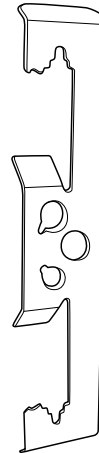

Depress the batwing clip until it securely clips onto ceiling wire or threaded rod

Note: The WBW34 attaches to 12-gauge wire or threaded rod up to 3/8"; the W6Z34 attaches to 5/16" to 3/8" threaded rod; the W8Z34 attaches to 1/2", 5/8" threaded rod

Mounting to a beam with a side mount hammer-on beam clamp

WHOK-24, WHOK-58

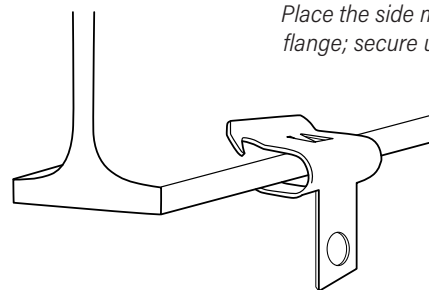

Place the side mount clip to the flange; secure using a hammer

Note: The WHOK-24 is used for flanges from 1/8" to 1/4" thick; the WHOK-58 is used for flanges from 5/16" to 1/2" thick

Mounting to a beam with a bottom mount hammer-on beam clamp

WM24, WM58, WM912

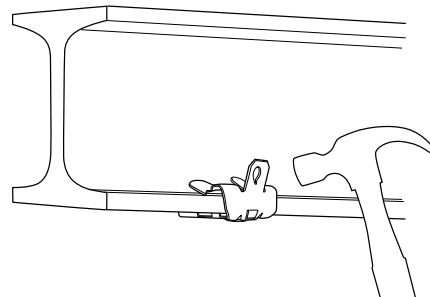

Place the side mount clip to the flange; secure using a hammer

Note: The WM24 is used for flanges from 1/8" to 1/4" thick; the WM58 is used for flanges from 5/16" to 1/2" thick; the WM912 is used for flanges from 9/16" to 3/4" thick

Mounting to a beam with a bolt-on malleable beam clamp

WMBC12, WMBC4T, WMBC4T-138, WMBC4T-WM

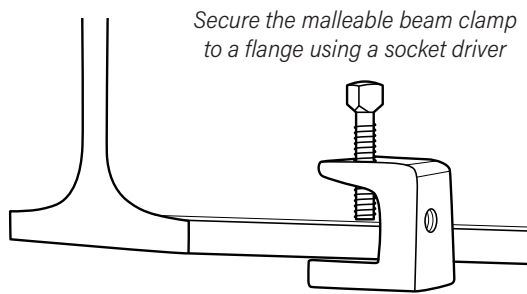

Note: The WMBC4T is used for flanges up to 3/4"; the WMBC12/ WMBC4T-138/ WMBC4T-WM is used for flanges up to 1-3/8"

Mounting to a Z purlin with a hammer-on beam clamp

WAF14, W122, W123

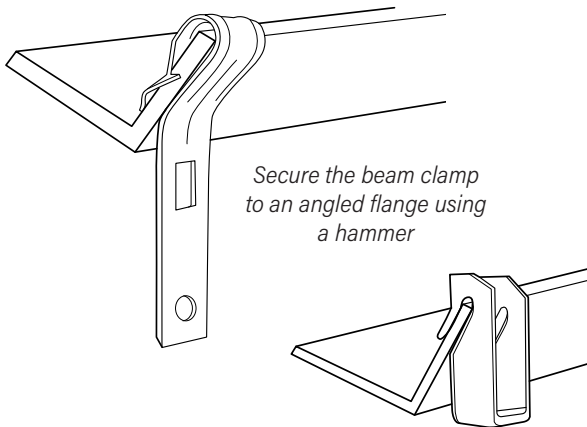

Note: The AF14 is used for 1/16"-1/4" flange; the W123 is used for 0.06-0.10" flange; the W122 is used for up to 1/16" flange

Mounting conduit to ceiling, threaded rod or structural attachment

W812M, W16M

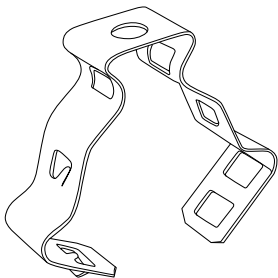

Mounting to concrete, masonry or metal surface using a powder actuated pin clip

WACPA, WACTUATED4T

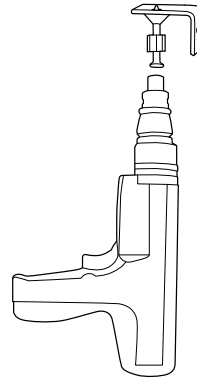

! WARNING

- Powder tool licensing required
- Never place hand over the muzzle end of a loaded gun
- Always use eye & hearing protection when using a power actuated tool

Mounting threaded rod to wall

W4TI, W6TI

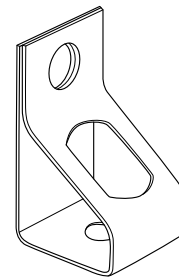

Static Load Rating

Part Number	Static Load Rating	Part Number	Static Load Rating
W122	100 lb	WAF14	100 lb
W123	100 lb	WANGLE4T	20 lb
W16M	100 lb	WANGLE4TSS	20 lb
W4TI	100 lb	WBW34	20 lb
W6TI	100 lb	WHOK-24	100 lb
W6Z34	20 lb	WHOK-58	100 lb
W812M	100 lb	WM24	20 lb
W8Z34	20 lb	WM58	20 lb
WAC	20 lb	WM912	20 lb
WAC12-300	20 lb	WMBC12	1500 lb
WAC38	20 lb	WMBC4T	450 lb
WAC4T-300	20 lb	WMBC4T-138	450 lb
WACPA	20 lb	WMBC4T-WM	450 lb
WACSS	20 lb	WPBC	100 lb
WACTUATED4T	20 lb	WSSBC	100 lb

Consult & follow local codes and practices. Optional suffix indicates color.

© Winnie Industries, LLC. All Rights Reserved. Drawings are proprietary and may not be copied or used without express written permission.

engineered and
manufactured to
make installs easier



5420 Newport Dr. Unit 62
Rolling Meadows, IL 60008

224-993-0011
sales@winnieindustries.com

winnieindustries.com

Rev 202503



Specify Winnie...

- ✓ Since 2015
- ✓ Family-Owned & Operated
- ✓ Personal & Friendly Customer Service